

TECHNICAL NOTE

ONE VALVE, TWO CHANNELS

Advanced
MicroFluidics
Innovative
automation solutions

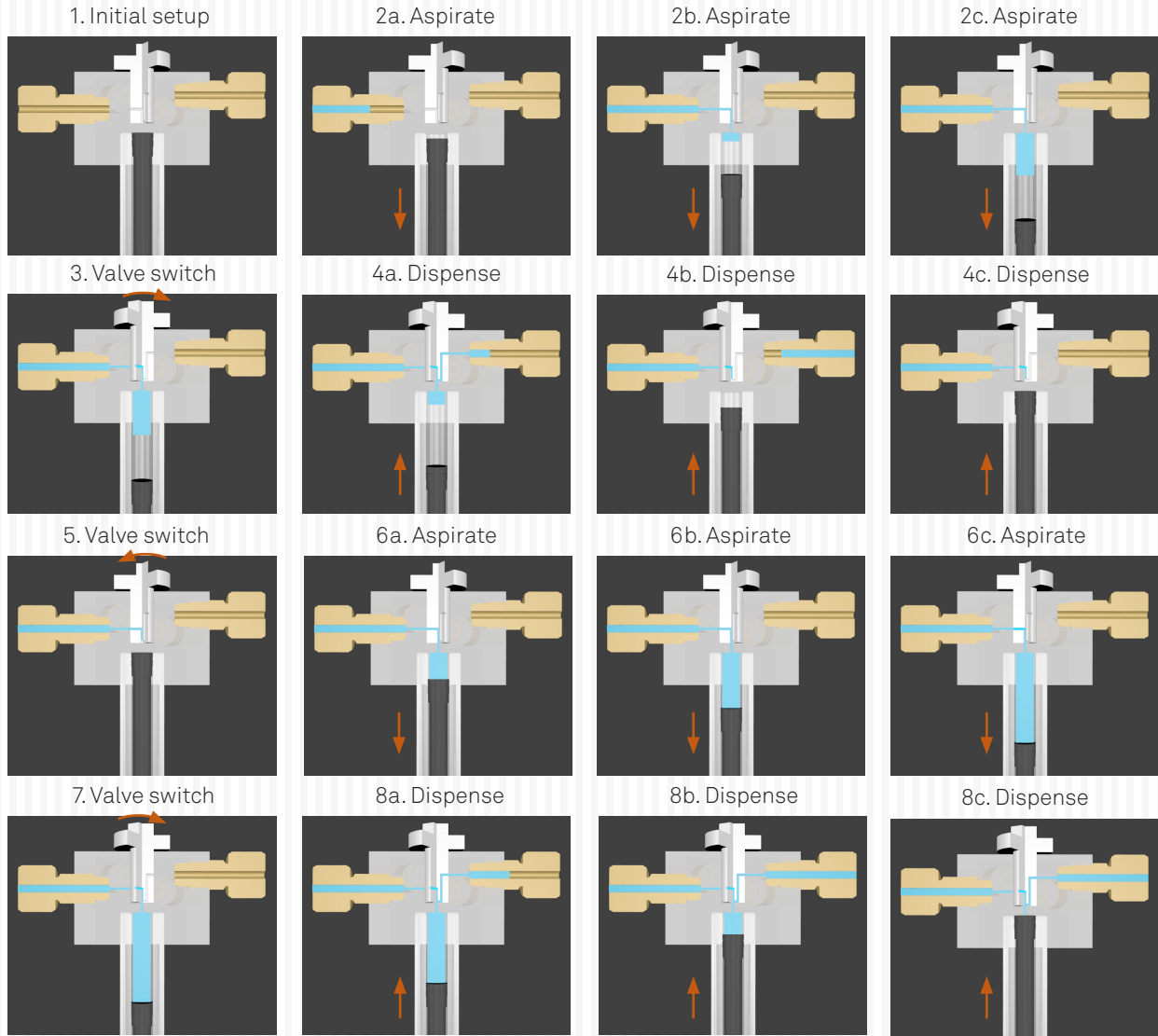

WHAT ARE WE DOING?

With our 2-stage distribution valve, VD2-6, we say that the carryover volume is smaller. But what really happens inside the valve?

Above is an example showing a typical initialisation sequence, usually called priming.

WHAT'S IN IT FOR YOU?

- A view of the insides of the valve
- An indepth comprehension
- An illustration of the ingenious system that we designed
- A limited carryover volume
- An automatic priming sequence in 8 movements only !

CONTACT US FOR MORE INFORMATION

Advanced Microfluidics SA
Ch. de la Dent d'Oche 1a
CH-1024 Ecublens
Switzerland

www.amf.ch
info@amf.ch
+41 21 552 14 30